

**CSH-1800** (Spring Applied Hydraulic Released)



◆ **Main Features**

- Emergency brake in case of over speed or loss of electrical supply
- Oil To be used : Use mineral oil (ISO-VG 46)

◆ **Operating Condition**

- Ambient temperature: -10°C ~ +60°C
- Relative humidity: ≤ 70%
- Dust in atmosphere: ≤ 65μ
- Other condition: consult CHASCO

◆ **Options**

- Indicate pad lining wear

◆ **Specification**

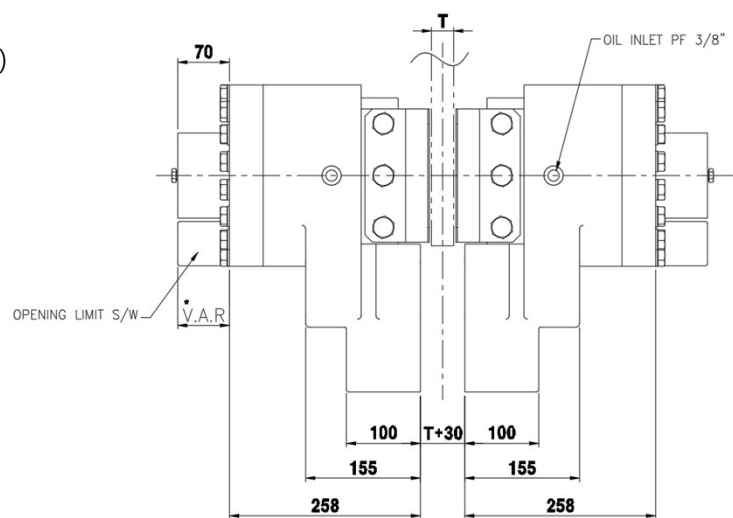
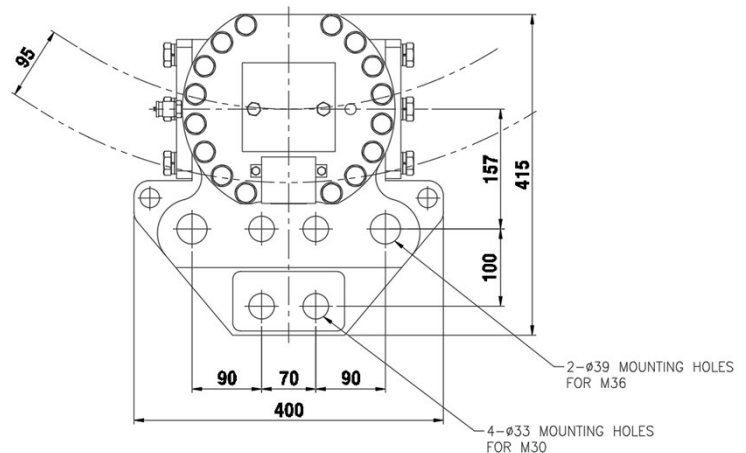

\* Depending on the proximity sensor specifications, apply 80~142

Model Type	CSH-1800	
Clamping Force (C.F) For 1mm of air gap(disc/lining) each side	kN	257
Braking Force (B.F) For 1mm of air gap(disc/lining) each side	kN	206
Linear speed of the disc for BF	m/s	≤ 10
Calculation Braking Torque (B.T)	N-m	$BT = B.F \times (D/2000 - 0.095)$
Release Pressure	Min. kgf/cm <sup>2</sup>	185
	Max. kgf/cm <sup>2</sup>	205
Wear Allowance of Pad lining	mm	6
Required oil volume	cc	120 for 1 stroke disc/Lining of 3 mm
Response Time at Nominal torque	sec	≤ 0.3
Weight	kg	270
Requested mounting bolts, strength and torque		2-M36, 12.9G, $\mu=0.14$ 4-M30, 12.9G, $\mu=0.14$